

THE VERDURE SYSTEM OF THE CZECH SMALL TOWNS

- THE SYSTEM OF THE OLD AND NEW AREAS AND STRUCTURES -



Author: **Ing. Matouš Jebavý, Ph.D.** – authorised landscape architect

Address: V Štíhlách 1311/3, 142 00 Praha 4 – Krč, matous.jebavy@atlas.cz

Tel.: +420 241 725 615, +420 606 824 266

- graduated from Ing. – programme at the Faculty of Agriculture of the Czech University of Agriculture in Prague in the year 1991 (CUA in Prague)
- graduated from Ph.D. – programme at the Department of Urban Design and Planning of the College of Architecture at the Czech Technical University in Prague in 2002 (FA CTU in Prague)
- tutor at the Czech University of Agriculture in Prague at the Department of Horticulture - head of the garden and landscape architecture studio
- member of the Czech Chamber of Architects (ČKA)
- member of the Czech Landscape Architects at the Czech Landscape and Garden Society (CZLA)
- member of the International Federation of Landscape Architects (IFLA)



2. The map of the Czech Republic

• HISTORICAL VIEWS OF CZECH SMALL TOWNS



3. Square of the town Česká Kamenice - the end of the 19. c.



4. Chlumec nad Cidlinou - the end of the 19. century



5. Chlumec nad Cidlinou - the beginning of the 20. c.



6. Landscape park in Chlumec nad Cidlinou - the beginning of the 20. century

The specific characteristic of the verdure system of the Czech small towns

Small towns in the Czech Republic represent one of the ideal form of the settlement. The verdure system of the Czech small towns is the system of the old and potential new verdure areas and verdure structures. The basic of the theme of the work was work out in my dissertation. For the analyses I chose five observed typical small towns in the Czech Republic. It is about Choceň, Chlumec nad Cidlinou, Nové Město nad Metují, Slatiňany and Česká Kamenice. It turns out that it is not possible to deal with the verdure of the intravilan of the small town and the linking landscape environment separately because the organism of the small town is firmly anchored in the linking landscape framework of each town. The neighbouring landscape saturates many of the claims of recreation of the small town and the landscape verdure significantly participates in the aesthetic quality of the long distance views of small town. The arrangement of the system areas of the verdure of the small town is in its development conditioned on the natural conditions of landscape framework of the town and historical, social, economic and cultural views of its development.

The structure of the verdure system

The basic functional areas of the verdure form with the connecting factors of verdure (the landscaped streets, embankments, alleys and avenues) the system of the verdure of the small town. The Czech small town is necessary to perceive like a space organism, it is necessary to deal with its space effectiveness and structure. From this results that the arrangement of the verdure of the individual public urban areas (the places, streets, embankments, parks, sports grounds, playgrounds for children etc.) is decisive for the formation of the relation its habitants and visitors to the given town.

• THEORETICAL SCHEME OF THE CZECH SMALL TOWN VERDURE SYSTEM

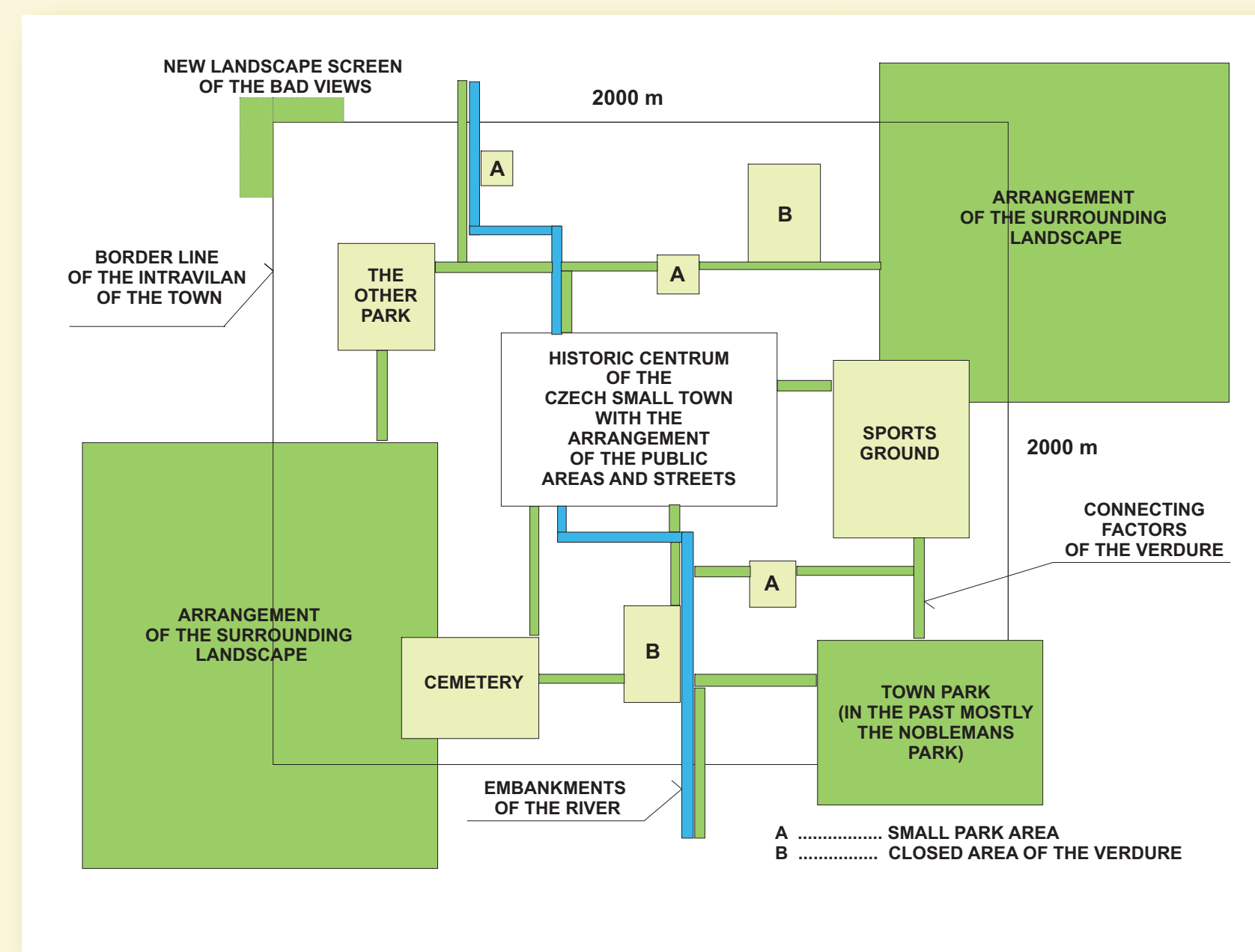

9. Theoretical scheme of the Czech small town verdure system

• CZECH SMALL TOWN AND ITS LANDSCAPE SURROUNDINGS

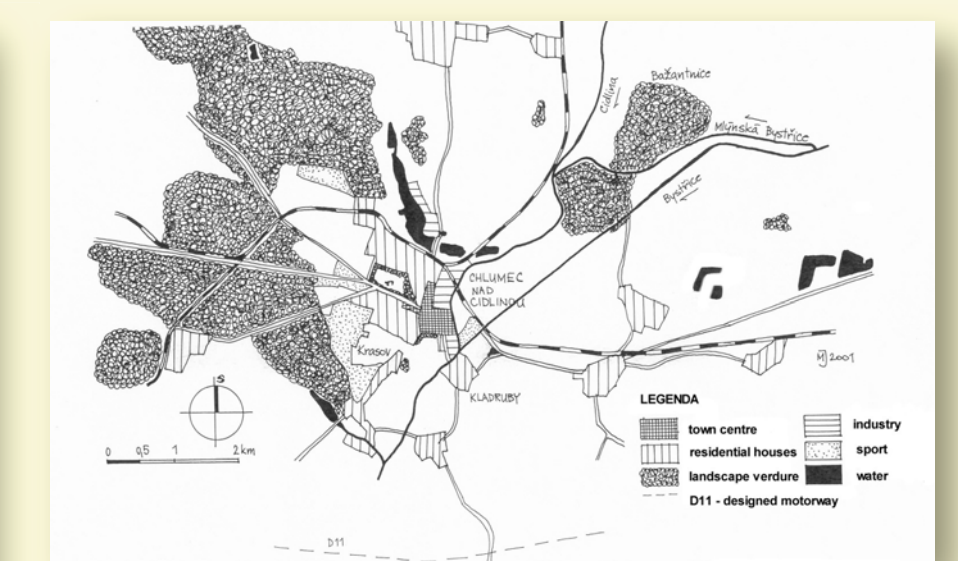

7. Chlumec nad Cidlinou and the landscape of the town

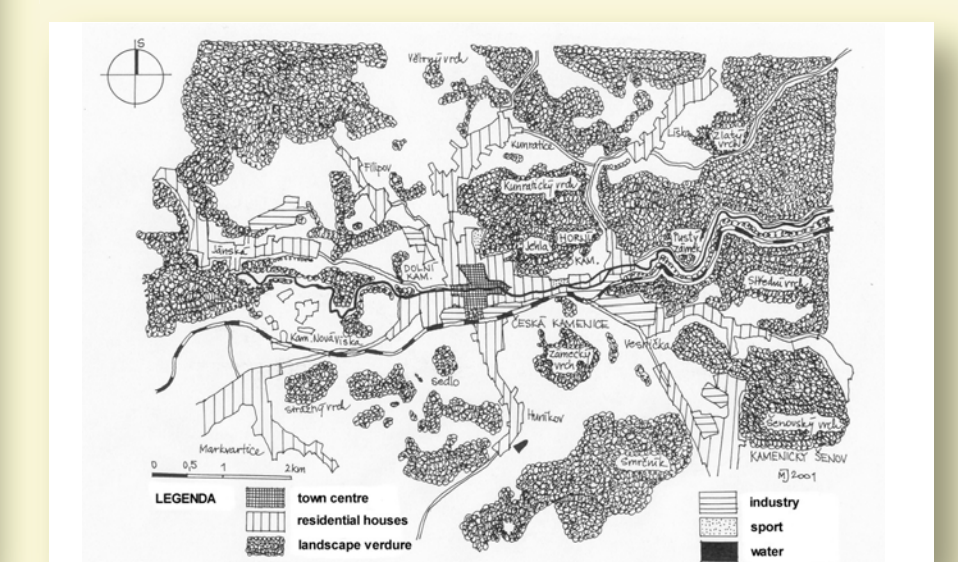

8. Česká Kamenice and the landscape of the town

The planning of the verdure system

The system of the verdure of the small town, in a complex way, is not solved in any of the observed small towns in the separate complex legal instrument. It appears that for the protection and the formation of the verdure system is useful to take advantage of the basic instruments of the urban planning that deal with the protection of the contemporary values and the future development of the organism of the small town and its linking environment. First of all, it is about the local plan of the small town and the regulation plan. The urban planning of the small town solves the development of the organism of the town from the complex view, and at the same time, the influence of proportion of all functions is taken into consideration. For the future it appears necessary use the landscape plan for the formulation of the verdure system of the Czech small towns. This document should be made by landscape architect. The individual forms of plans solving concrete arrangement of the verdure of the spaces and the areas of the small town are most important by the realisation of the individual parts of the verdure system of the Czech small towns.

• THE ANALYSIS OF THE VERDURE FUNCTIONAL AREAS IN CZECH SMALL TOWNS



10. Choceň

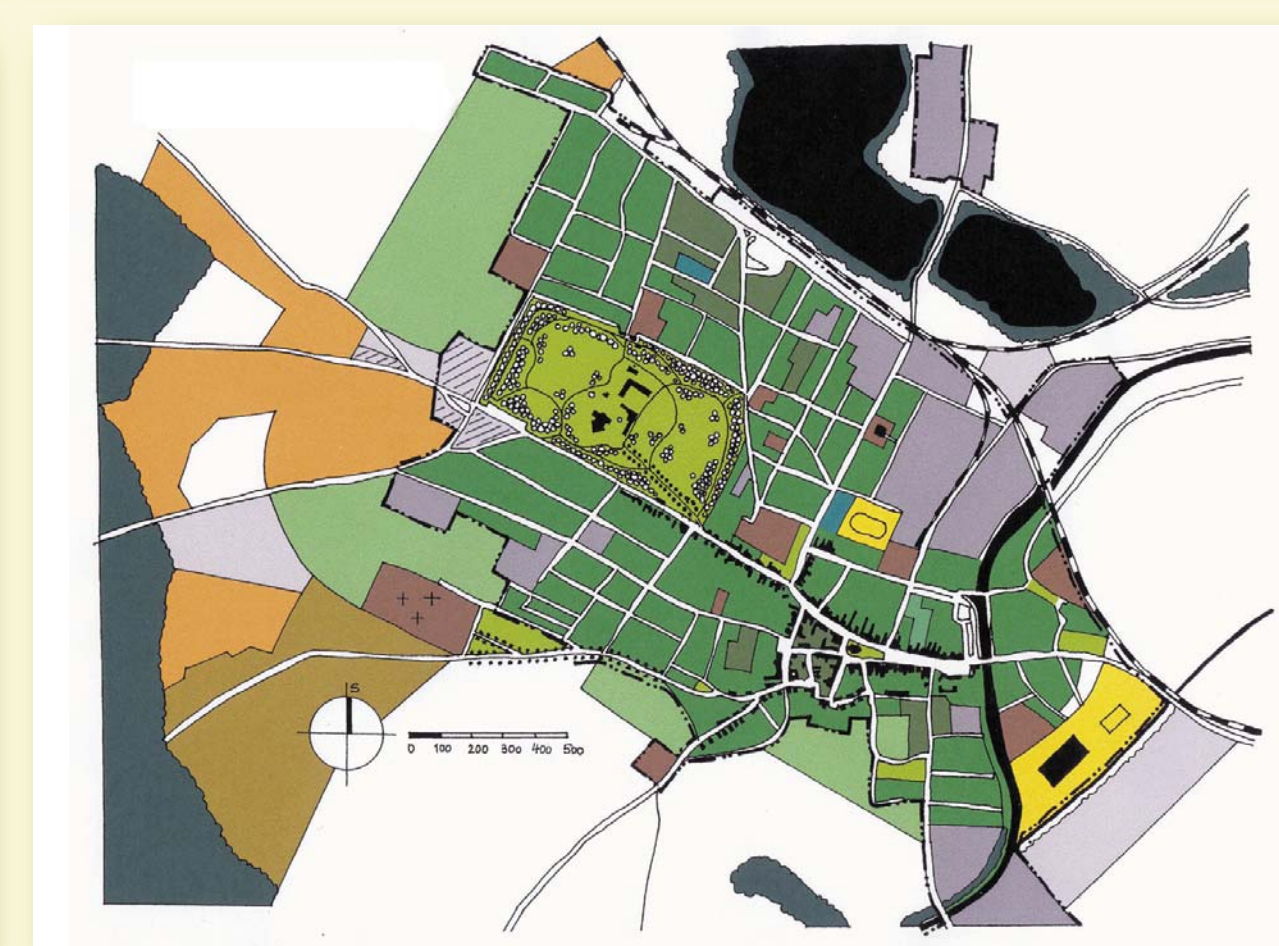

11. Chlumec nad Cidlinou

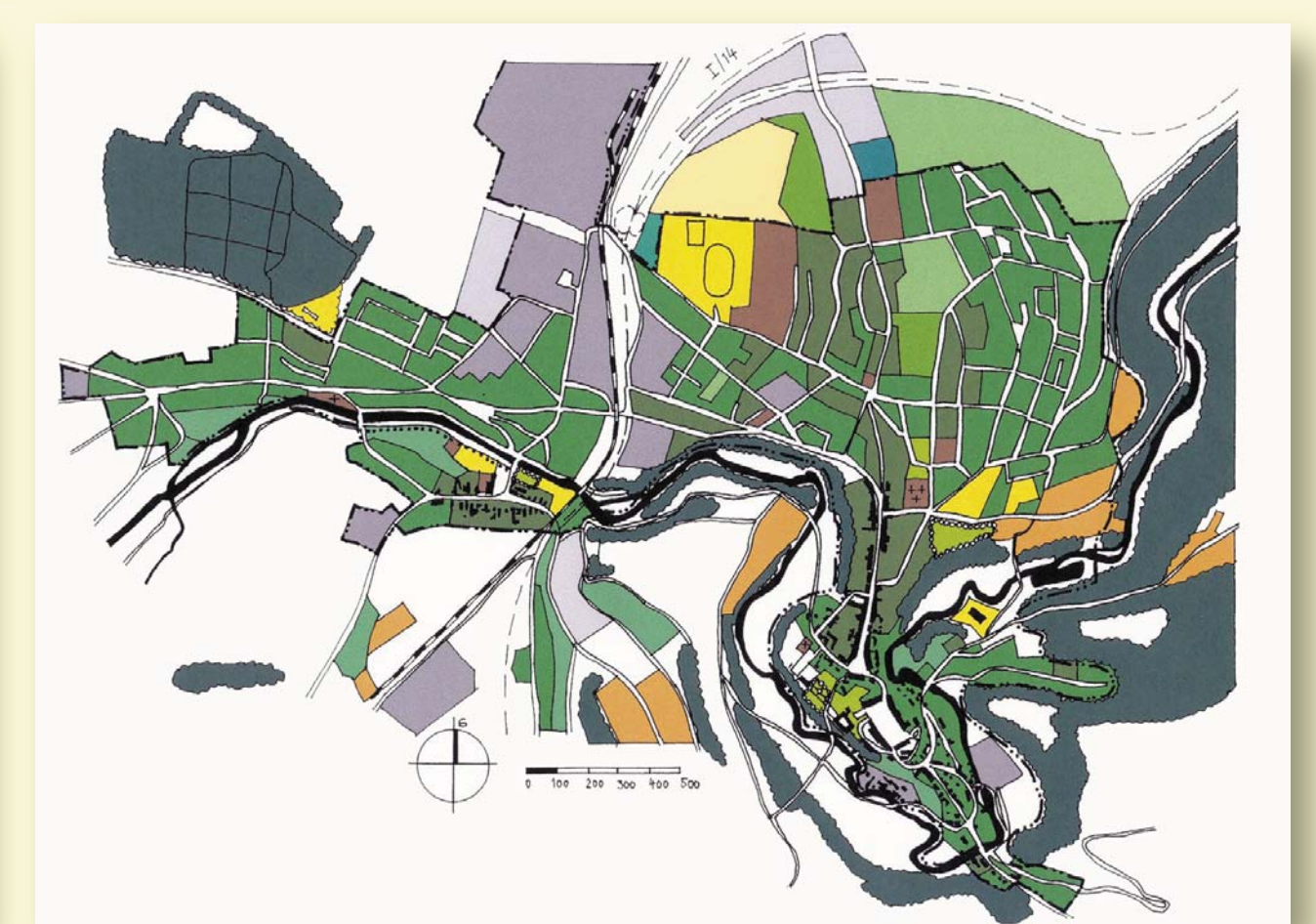

12. Nové Město nad Metují

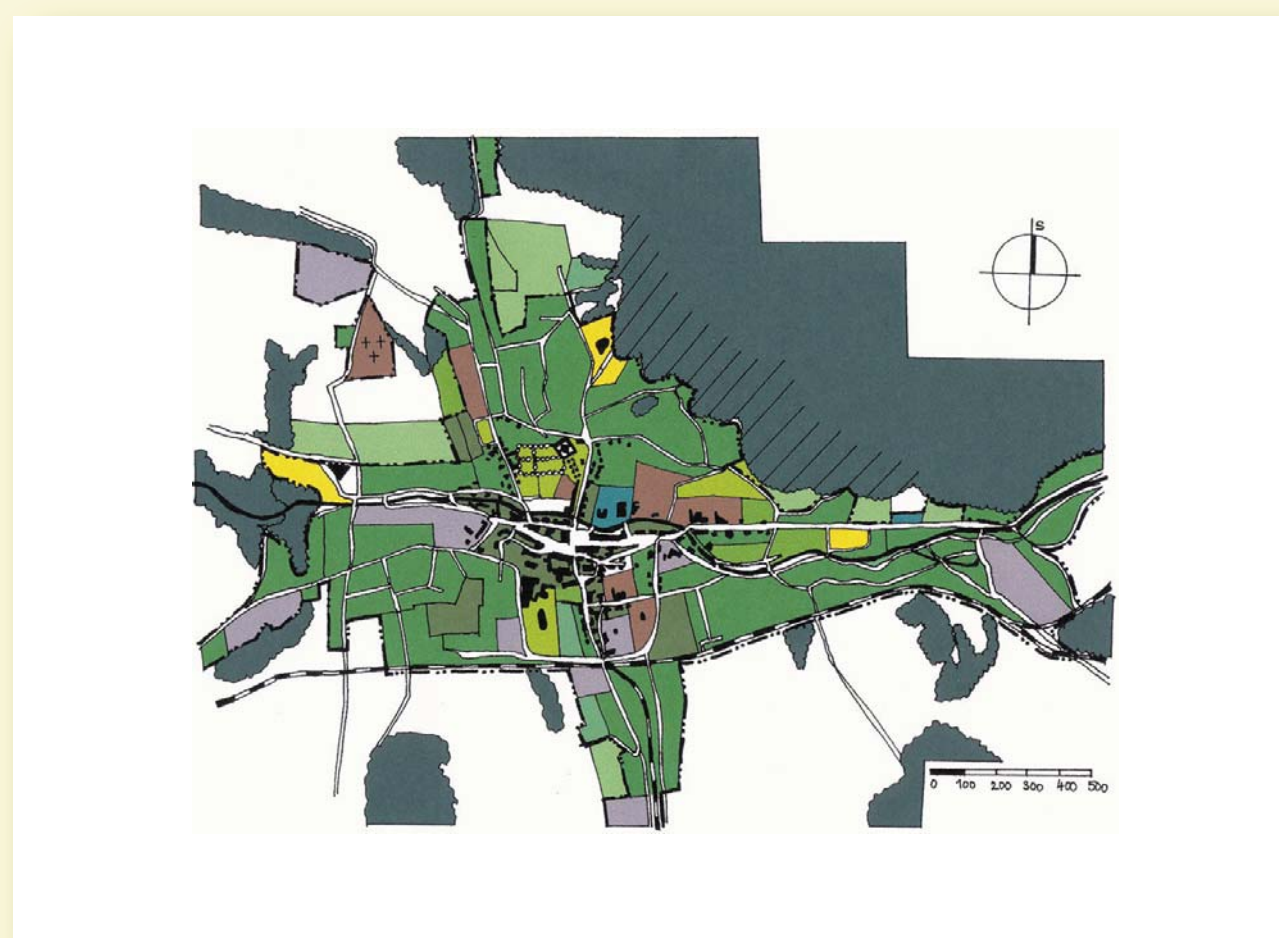

13. Česká Kamenice

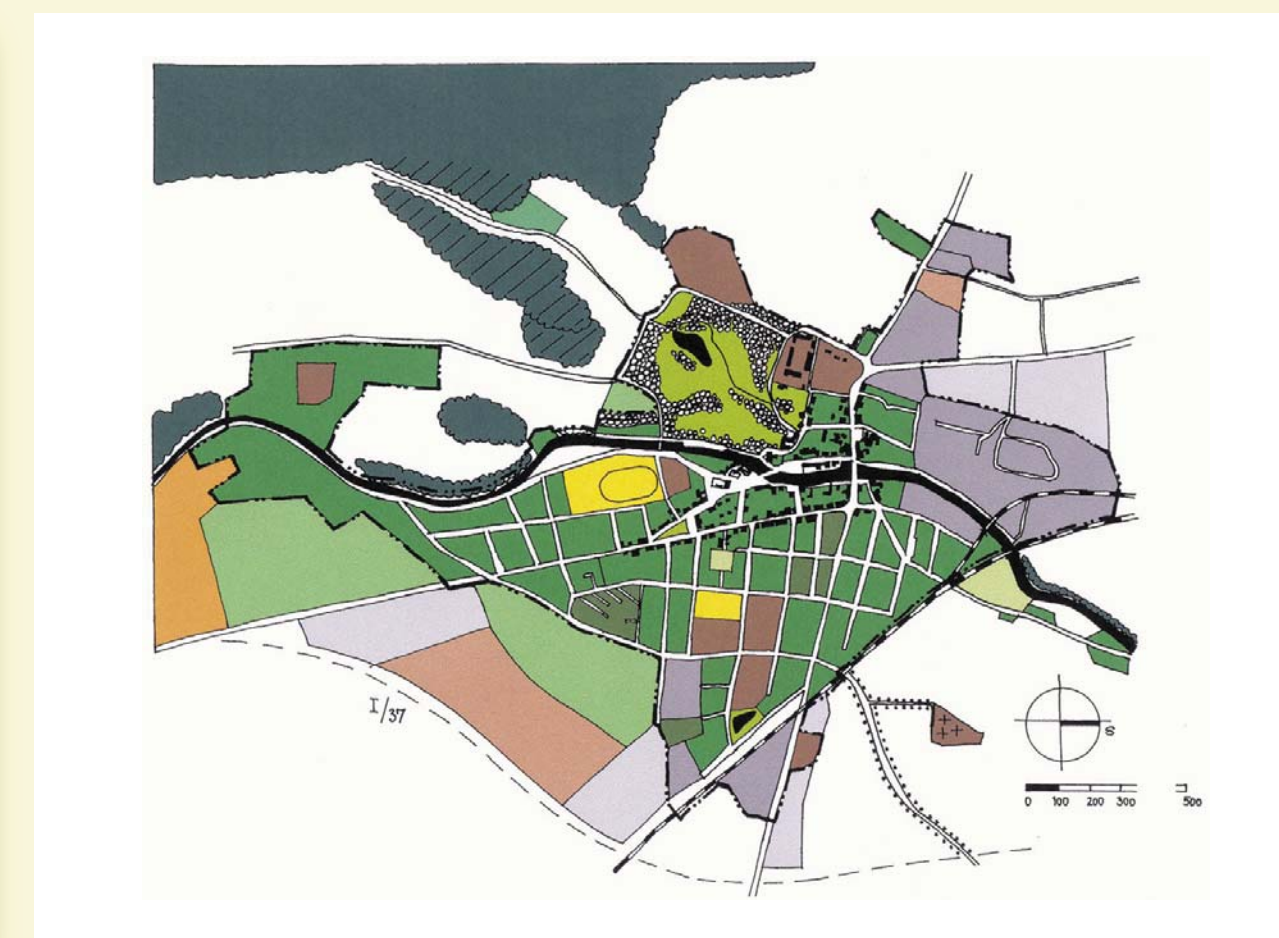

14. Slatiňany

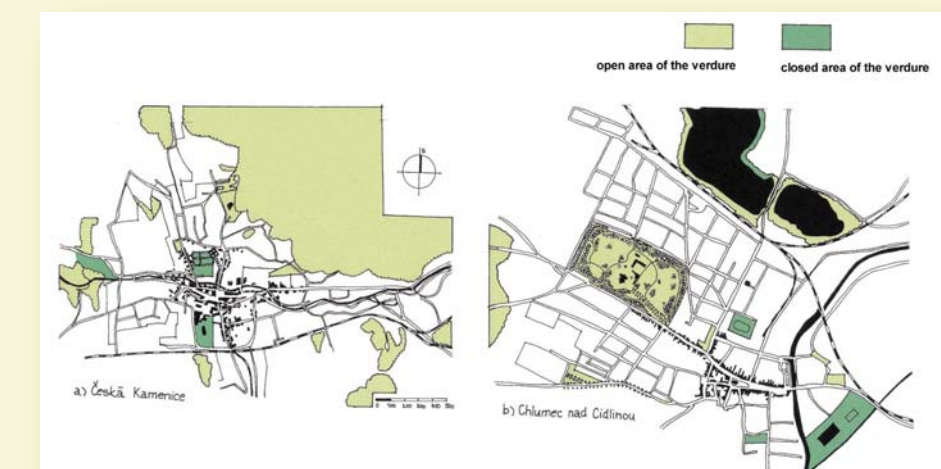

16. Arrangement of the verdure areas in small town in the mountains and in the flat landscape

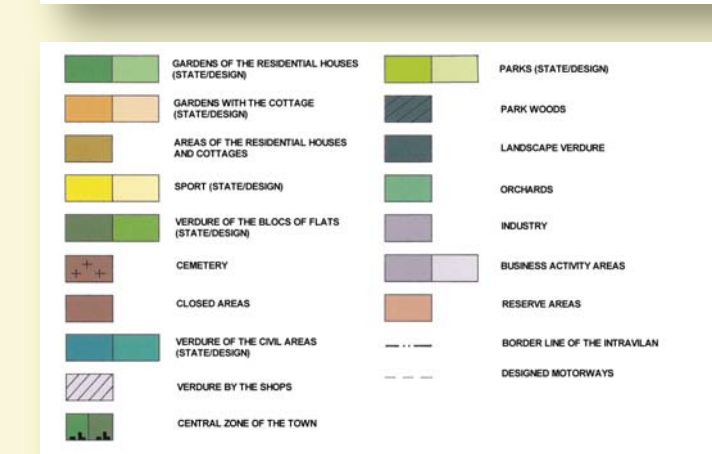

15. Explanation

• AUTHOR'S PROJECTS FOR THE RENOVATION OF THE PARTICULAR AREAS OF THE VERDURE IN CZECH SMALL TOWNS

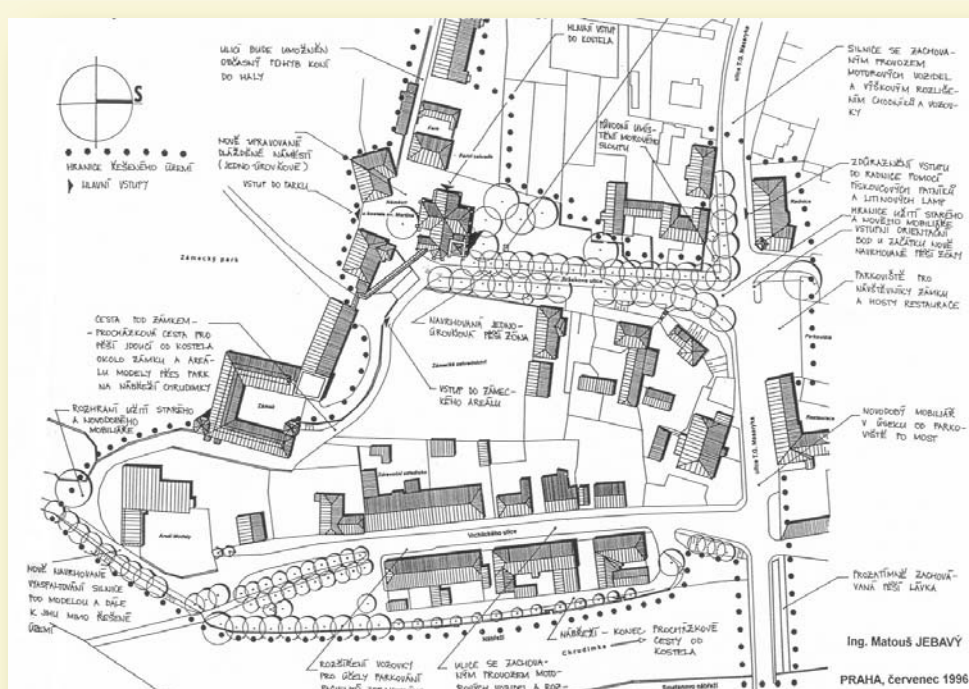

17. Study of the central zone of the town Slatiňany

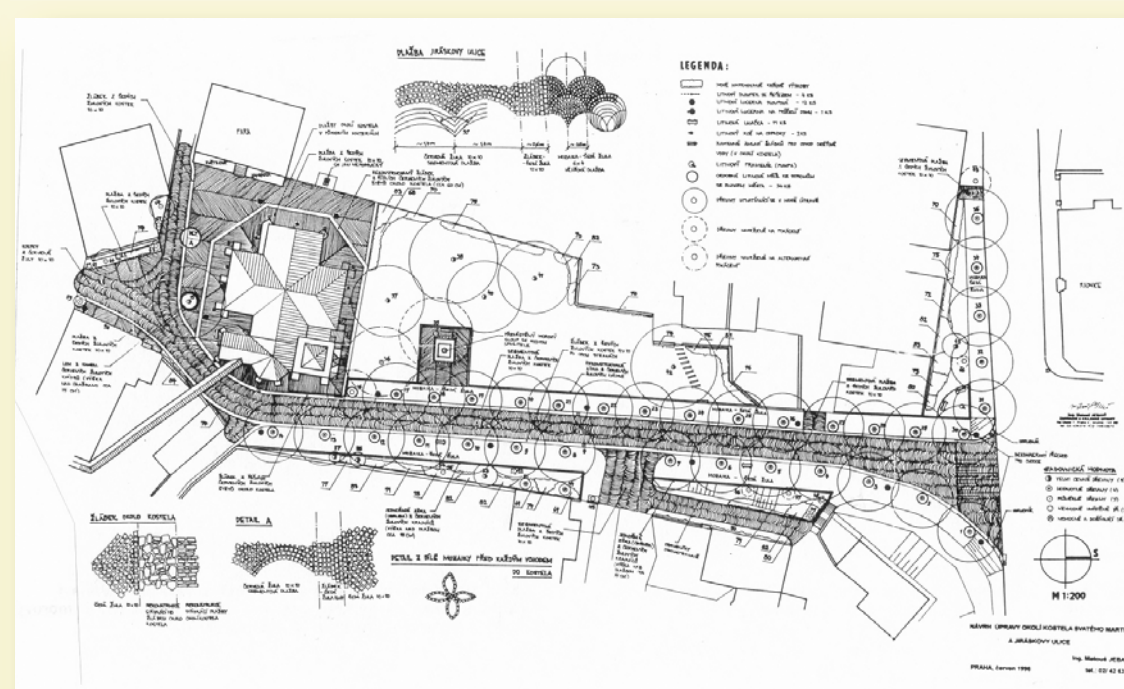

18. Pedestrian zone in Slatiňany

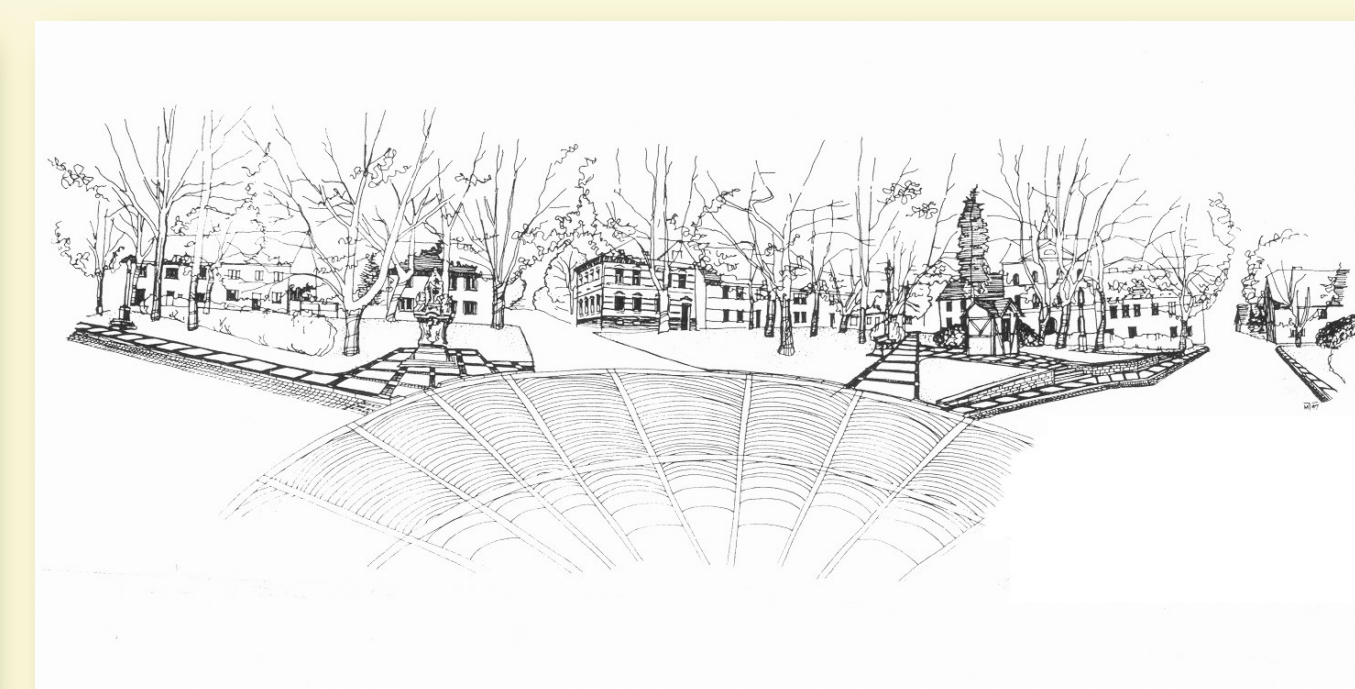

19. Arrangement of the square in Výsluní near Chomutov

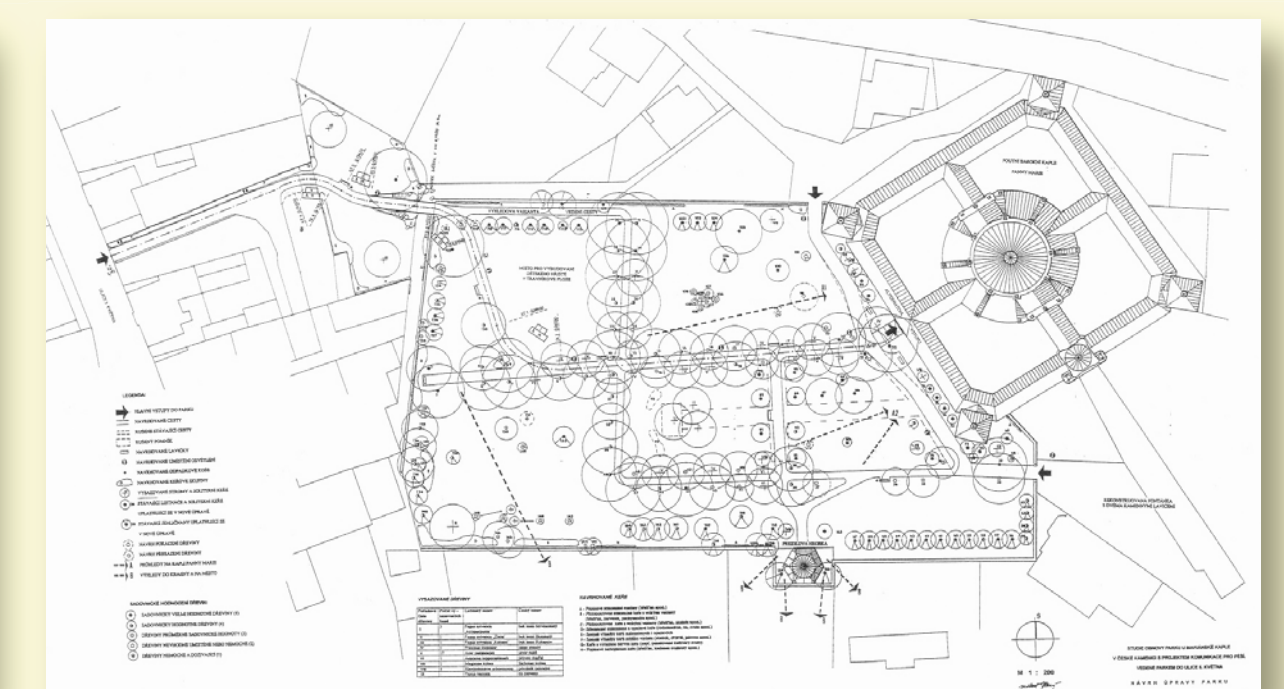

20. Park in Česká Kamenice